

# LEGISLATIVE COUNCIL BRIEF

Road Traffic Ordinance  
(Chapter 374)

## **Road Traffic (Traffic Control) (Designation of Prohibited and Restricted Zones) (Amendment) Notice 2007**

### **Designation of Prohibited Zones and Restricted Zones at the Airport**

#### **INTRODUCTION**

The Road Traffic (Traffic Control) (Designation of Prohibited and Restricted Zones) (Amendment) Notice 2007 (“the Amendment Notice”), at **Annex A**, has been made to amend Section 1, Section 3, Schedule 1 and Schedule 2 to the Road Traffic (Traffic Control) (Designation of Prohibited and Restricted Zones) Notice (Cap. 374, sub. leg. U) (“the Notice”). The amendments are introduced to designate the prohibited and restricted zones at the Hong Kong International Airport (“the airport”) to segregate the loading and unloading activities of the light goods vehicles (“LGVs”) and to deter illegal transport activities of LGVs and taxis at the airport area. The Amendment Notice was made by the Airport Authority Hong Kong (“AA”) with the approval of the Commissioner for Transport under regulation 14(1) of the Road Traffic (Traffic Control) Regulations (Cap. 374 sub. leg. G), as modified by section 1 of Part V of Schedule 2 to the Airport Authority Bylaw (Cap. 483 sub. leg. A).

Annex A

#### **BACKGROUND**

2. It is noted that some LGVs and individual vehicles of other types have been carrying out illegal transport activities including soliciting and illegal carriage of passengers for hire or reward at the airport area such as car parks near the passenger terminal of the airport. Similar forms of illegal transport activities such as soliciting are also carried out by some taxis at the airport. Not only that the activities are illegal, they are causing conflicts among different transport trades as well as between the drivers and passengers.

3. In addition to stepping up enforcement by the Police, the relevant government bureaux / departments and AA have been working together since April 2006 on the feasibility of introducing new administrative measures at the airport in order to further combat these illegal transport activities and to respond to the request from the taxi trade for separating the picking up / setting down of passengers and loading / unloading of goods at the airport. Having considered the views expressed by both LGV and taxi trades and examined the operation of the two trades at the airport, a traffic management scheme of designating LGV Access, Loading and Unloading Areas at the airport has been worked out.

4. The scheme includes the provision of new LGV Access, Loading and Unloading Areas for LGVs at the existing Government Car Park and Car Park No. 1 at the airport, with appropriate prohibition and restrictions. The Areas have been under construction since early 2007 and are scheduled to come into operation on 14 July 2007. As part of the management scheme, taxis and LGVs will be prohibited from using the airport Car Parks Nos. 1, 2 and 4 (multi-storey car park) upon the commissioning of the LGV Access, Loading and Unloading Areas.

5. The prohibition and restrictions will reduce the areas of illegal activities of taxis and LGVs at the airport by barring their usage of car parks near the passenger terminal, thus enabling the Police to concentrate their resources for monitoring and taking more focused enforcement actions against illegal transport operations at the airport. The scheme will not affect LGV drivers conducting legitimate freight business at the airport since they can make use of this new loading and unloading areas for LGVs to be provided.

## **THE AMENDMENT NOTICE**

### Annex A

6. The Amendment Notice at Annex A amends the Notice to designate the concerned prohibited and restricted zones. The Amendment Notice also adds a definition of “overall length” as motor vehicles with overall length exceeding seven metres will be prohibited from using the

access road linking Cheong Shun Road and the LGV Access Area given design and technical constraints.

7. The prohibited zones and restricted zones designated under the Amendment Notice at the airport are set out below. Two plans numbered TSP/000/C/1151/A and TSP/000/C/1152/A are enclosed at **Annex B**.

Annex B

**Prohibited Zones** (Plan numbered TSP/000/C/1151/A at Annex B)

- (a) Prohibit the driving of all goods vehicles and taxis (except a vehicle in respect of which a prohibited zone permit is in force) on any road within:
  - The area of Car Park No. 1 and Government Car Park;
  - The Car Park No. 2;
  - The Car Park No. 4 (multi-storey car park);
- (b) prohibit the driving of all motor vehicles (except a vehicle in respect of which a prohibited zone permit is in force) except LGVs on any road within the new LGV Access, Loading and Unloading Areas;
- (c) prohibit the driving of any motor vehicles with overall length exceeding seven metres on the access road linking Cheong Shun Road and the new LGV Access Area; and

**Restricted Zones** (Plan numbered TSP/000/C/1152/A at Annex B)

- (d) prohibit the driver of any motor vehicles (except the driver of a motor vehicle in respect of which a restricted zone permit is in force) from loading or unloading goods and picking up or setting down passenger on any road within the new LGV Access, Loading and Unloading Areas, except for LGVs which can load and unload goods in the respective Loading and Unloading Areas.

8. At present, all designation of prohibited and restricted zones on designated roads in the airport are made under regulation 14(1) of the Road Traffic (Traffic Control) Regulations (Cap. 374 sub. leg. G), as modified by section 1 of Part V of Schedule 2 to the Airport Authority Bylaw (Cap. 483 sub. leg. A). Under this regulation, AA with the approval of the Commissioner for Transport is empowered to designate any area as a prohibited zone or a restricted zone by notice in the Gazette.

### **LEGISLATIVE TIMETABLE**

9. The Legislative timetable will be –

Publication in the Gazette	18 May 2007
Tabling at the Legislative Council	23 May 2007

### **IMPLEMENTATION**

10. The effective date of the prohibited and restricted zones shall be 14 July 2007, to tie in with the commissioning of the LGV Access, Loading and Unloading Areas at the airport.

### **IMPLICATIONS**

11. The construction and the future management of the LGV Access, Loading and Unloading Areas are funded by AA. The Amendment Notice would not affect the binding effect of the existing legislation, and it is in conformity with the Basic Law, including the provisions concerning human rights. It has no financial and staffing implication for the Government, and no major economic implications. The scheme has no productivity and environmental implications.

## **PUBLIC CONSULTATION**

12. The Transport Advisory Committee was consulted on this subject on 21 November 2006 and the Legislative Council Panel on Transport on 24 November 2006. The former supported and the latter had no objection to the scheme.

13. Both the taxi and LGV trades were consulted on the details of the scheme at various meetings held in 2006. We have taken into account the trades' views when finalising the scheme. Some members of the taxi trade have been urging for early implementation of the scheme.

## **PUBLICITY**

14. A spokesman will be available for handling enquiries. We will arrange publicity including distribution of leaflets at the airport and briefings for the LGV and taxi trades.

## **ENQUIRIES**

15. Any enquiry on this brief should be addressed to Ms Emily Mo, Assistant Secretary for the Environment, Transport and Works, at 2189 2101.

Environment, Transport and Works Bureau  
Airport Authority Hong Kong  
May 2007

**ROAD TRAFFIC (TRAFFIC CONTROL)(DESIGNATION  
OF PROHIBITED AND RESTRICTED ZONES)  
(AMENDMENT) NOTICE 2007**

(Made by the Airport Authority with the approval of the Commissioner for Transport under regulation 14(1) of the Road Traffic (Traffic Control) Regulations (Cap. 374 sub. leg. G), as modified by section 1 of Part V of Schedule 2 to the Airport Authority Bylaw (Cap. 483 sub. leg. A))

**1. Commencement**

This Notice shall come into operation on 14 July 2007.

**2. Interpretation**

Section 1 of the Road Traffic (Traffic Control) (Designation of Prohibited and Restricted Zones) Notice (Cap. 374 sub. leg. U) is amended by adding –

““overall length” (全長度) has the meaning assigned to it by regulation 2 of the Road Traffic (Construction and Maintenance of Vehicles) Regulations (Cap. 374 sub. leg. A);”.

**3. Designation of restricted zones**

(1) Section 3 is amended by repealing “Each area specified in column 1 of Schedule 2” and substituting –

“(1) Each area specified in column 1 of Part 1 of Schedule 2”.

(2) Section 3 is amended by adding –

“(2) Each area specified in column 1 of Part 2 of Schedule 2 is designated as a restricted zone in which the driver of any motor vehicle specified in column 2 opposite to that area (except the driver of a motor vehicle in respect of which a restricted zone permit is in force) is prohibited absolutely from doing any act specified in column 3 opposite to that motor vehicle.”.

#### 4. Prohibited zones

Schedule 1 is amended by adding –

- “5. Light Goods Vehicles Access Area, Light Goods Vehicles Loading Area and Light Goods Vehicles Unloading Area to the east of Cheong Shun Road, being the area shown in yellow on a plan numbered TSP/000/C/1151A and deposited in the head office of the Authority. All motor vehicles except light goods vehicles.
6. The access road linking Cheong Shun Road and Light Goods Vehicles Access Area to the east of Cheong Shun Road, being the area shown in red on a plan numbered TSP/000/C/1151A and deposited in the head office of the Authority. All motor vehicles exceeding 7 m in overall length.
7. (a) Car Park No. 1 and Government Car Park to the east of Cheong Shun Road, being the area shown in blue on a plan numbered TSP/000/C/1151A and deposited in the head office of the Authority. All goods vehicles and taxis.”.

deposited in the head office of the Authority.

(b) Car Park No. 2 to the north-west of Airport South Interchange, being the area shown in green on a plan numbered TSP/000/C/1151A and deposited in the head office of the Authority.

(c) Car Park No. 4 (multi-storey car park) to the west of the access road linking northern and southern parts of Cheong Tat Road, being the area shown in pink on a plan numbered TSP/000/C/1151A and deposited in the head office of the Authority.

## **5. Restricted Zones**

(1) Schedule 2 is amended by adding immediately after the heading “RESTRICTED ZONES” –

“PART 1”.

(2) Schedule 2 is amended, in Part 1, in item 4, in column 1, by adding –



“(d) Light Goods Vehicles Access Area to the east of Cheong Shun Road, being the area shown in yellow on a plan numbered TSP/000/C/1152A and deposited in the head office of the Authority.”.

(3) Schedule 2 is amended by adding immediately after item 7 –

## “PART 2

Column 1	Column 2	Column 3
1. Light Goods Vehicles Unloading Area to the east of Cheong Shun Road, being the area shown in red on a plan numbered TSP/000/C/1152A and deposited in the head office of the Authority.	(a) Light goods vehicles. (b) Other motor vehicles.	Loading goods. Picking up passengers, setting down passengers, loading goods and unloading goods.
2. Light Goods Vehicles Loading Area to the east of Cheong Shun Road, being the area shown in green on a plan numbered TSP/000/C/1152A and deposited in the head office of the	(a) Light goods vehicles. (b) Other motor vehicles.	Unloading goods. Picking up passengers, setting down passengers, loading goods and unloading goods.”.

Authority.



Chairman,  
Airport Authority

10 May 2007

#### **Explanatory Note**

The Road Traffic (Traffic Control)(Designation of Prohibited and Restricted Zones) Notice (Cap. 374 sub. leg. U) (“the Principal Notice”) sets out in Schedule 1 prohibited zones in which the driving of motor vehicles is prohibited. Schedule 2 of the Principal Notice sets out restricted zones in which drivers of motor vehicles are prohibited from picking up or setting down passengers or loading or unloading goods (“prohibited acts”). This Notice amends the Principal Notice to facilitate the operation of a new loading and unloading area for light goods vehicles at the Hong Kong International Airport.

2. As part of the arrangement, 3 new areas are designated as prohibited zones for all motor vehicles except light goods vehicles, all motor vehicles exceeding 7 m in overall length and all goods vehicles and taxis respectively. A definition of “overall length” is added as motor vehicles are specified with reference to the overall length for one new prohibited zone (sections 2 and 4).

3. This Notice divides Schedule 2 into 2 parts. A new restricted zone (Light Goods Vehicles Access Area) is added to Part 1 of that Schedule in which drivers of all motor vehicles are absolutely prohibited from doing any of the

prohibited acts. Two new restricted zones (Light Goods Vehicles Loading Area and Light Goods Vehicles Unloading Area) are added to Part 2 of that Schedule. In these two restricted zones, drivers of all motor vehicles except light goods vehicles are absolutely prohibited from doing any of the prohibited acts; drivers of light goods vehicles are prohibited only from unloading goods in the loading area and loading goods in the unloading area (sections 3(1) and (2) and 5(1), (2) and (3)).

**Plans illustrating the prohibited and restricted zones**

- Drawing No. TSP/000/C/1151/A (Annex I)
- Drawing No. TSP/000/C/1152/A (Annex II)

# ANNEX I

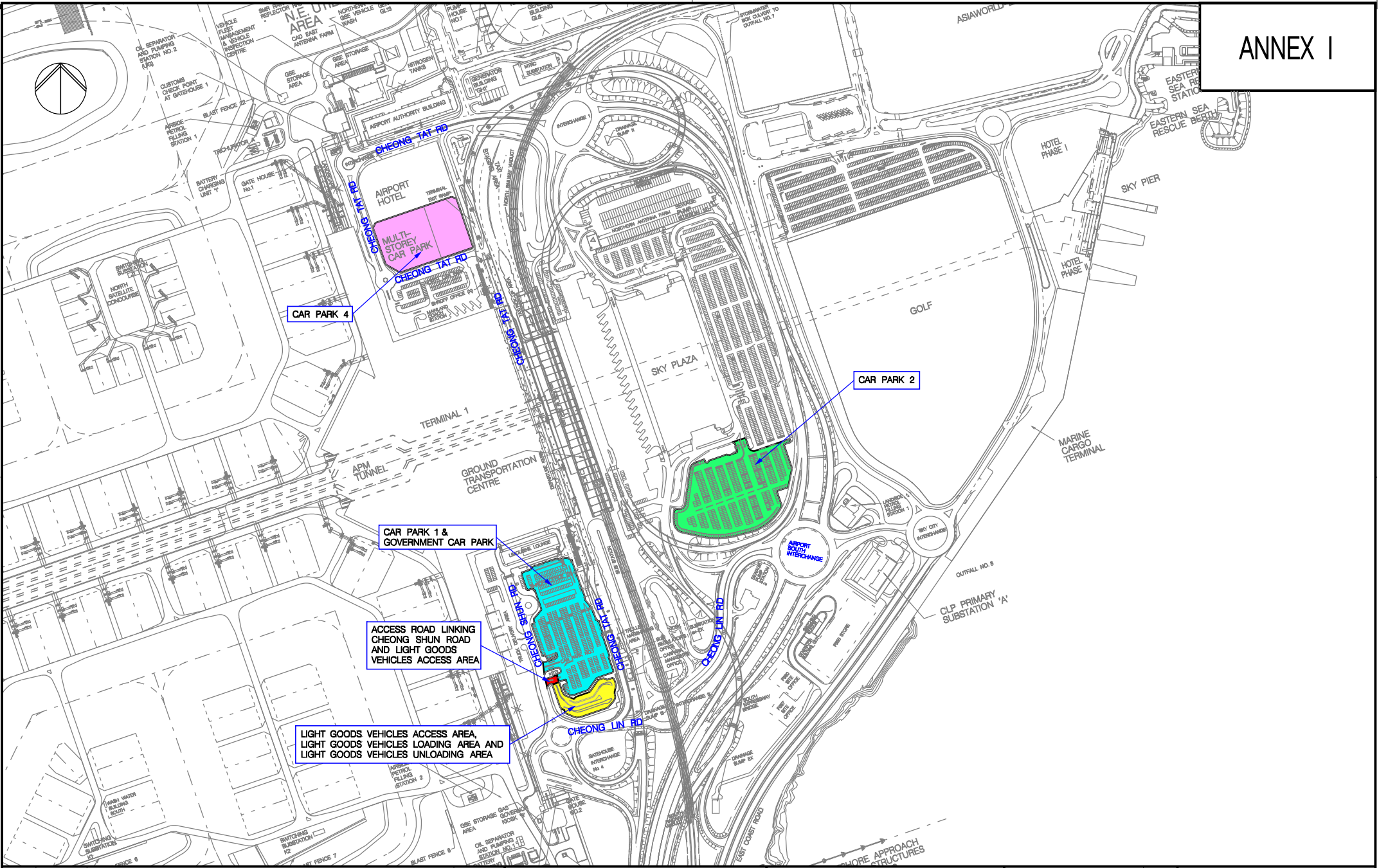

Rev.	Date	Description	Checked
A	16-APR-07	FIRST ISSUE	B. AU YEUNG

Airport Authority  
 HKIA Tower, 1 Sky Plaza Road,  
 Hong Kong International Airport,  
 Lantau, Hong Kong.  
 Tel : (852) 2188 7111  
 Fax : (852) 2824 0717



香港國際機場  
 HONG KONG INTERNATIONAL AIRPORT

Title  
**PROHIBITED ZONES AT AIRPORT**

Signatures for Approval  
 Design Supervisor :  
 L. KWONG  
 Checkers :  
 B. AU YEUNG  
 Authorised Representative :  
 S. LAM

Date  
 Hong Kong International Airport  
 Drawing No.  
**TSP / 000 / C / 1151**  
 Scale  
 1 : 5000 (A3)  
 Rev. A

# ANNEX II

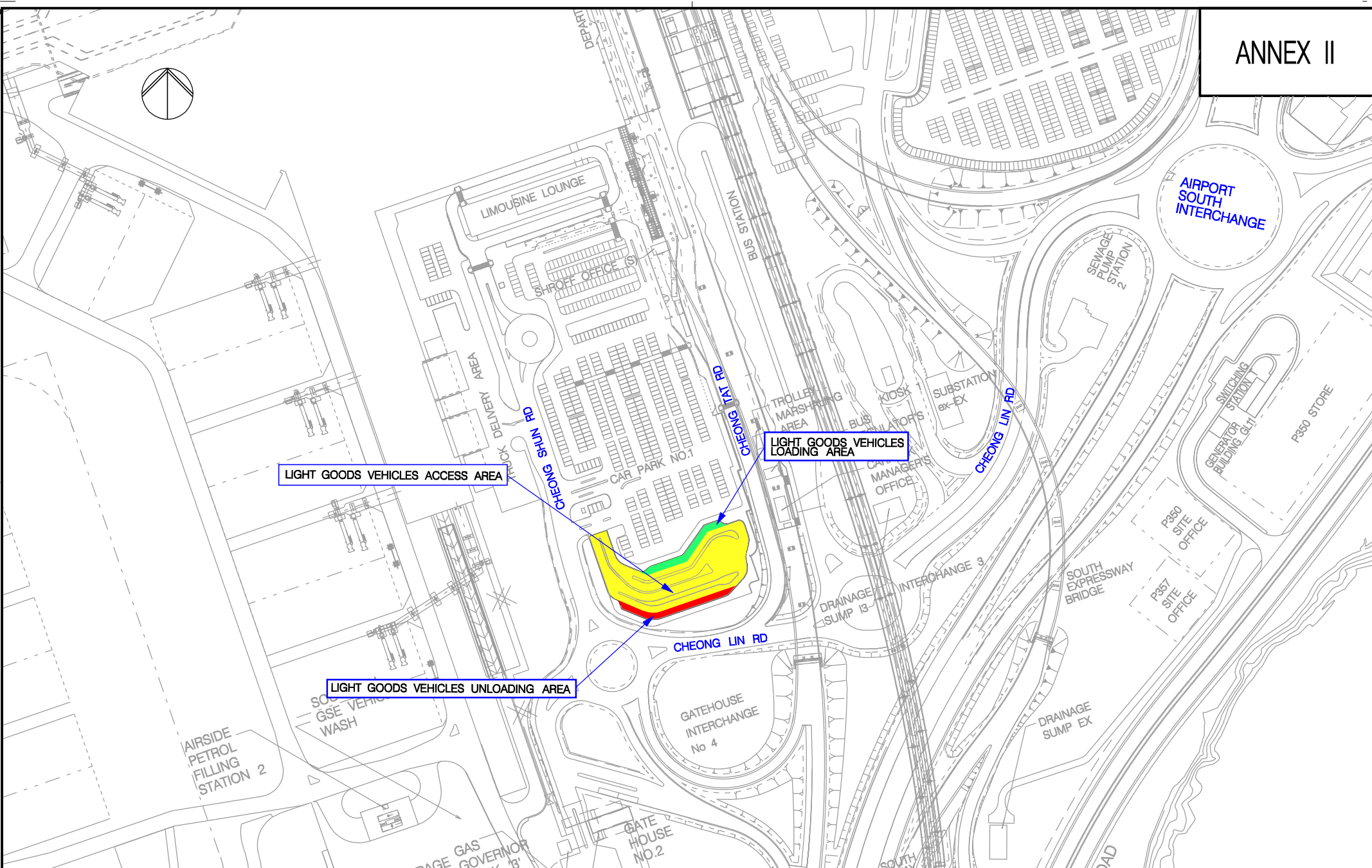

Rev.	Date	Description	Checked
A	16-APR-07	FIRST ISSUE	B. AU YEUNG

Airport Authority  
 HKIA Tower, 1 Sky Plaza Road,  
 Hong Kong International Airport,  
 Lantau, Hong Kong.



香港國際機場  
 HONG KONG INTERNATIONAL AIRPORT

Tel : (852) 2188 7111  
 Fax : (852) 2824 0717

Title  
**RESTRICTED ZONES AT AIRPORT**

Signatures for Approval  
 Design Supervisor :  
 L. KWONG  
 Checkers :  
 B. AU YEUNG  
 Authorised Representative :  
 S. LAM

Date  
 Hong Kong International Airport  
 Drawing No.  
**TSP / 000 / C / 1152**  
 Scale  
 1 : 2000 (A3)  
 Rev.  
 A